

KH ceramic wire temperature sensor

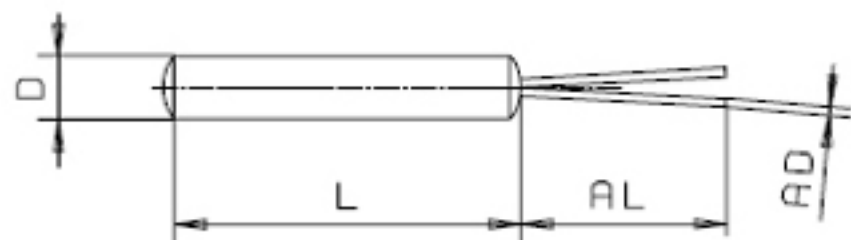

Temperature	-200°C to +1000°C
Specification	A platinum wire core is embedded in a ceramic substrate. The leads are resistant to shearing forces.
Tolerance classes	B in accordance with DIN IEC 751
Connection material	Platinum / rhodium 5%
Long-term stability	Hysteresis free, even after temperature fluctuations
Vibration resistance	Limited resistance to vibration and shock
Mechanical stability	Sensitive to external forces and pressure
Ambient conditions	Use unprotected only in dry environments
Special properties	<ul style="list-style-type: none"> - Wider temperature range - Good temperature stability
Applications	<ul style="list-style-type: none"> - When precision and stability of a platinum element are required over a wide temperature range
Special version	<ul style="list-style-type: none"> - Various lead lengths - Extended terminal leads



KH	Order no.	Nominal resistance Ω at 0 °C	Dimensions in mm				Sself heating K/mW at 0 °C	Response time in seconds	
			L	D	AL	AD		Water $v = 0.4$ m/s $t_{0.5}$	Air $v = 1$ m/s $t_{0.5}$
Class B									
4527	SB0589	100	45	2.7	15	0.35	0.07	0.5	14

Dimension tolerance: L = ± 1 , D = ± 0.15 , AL = ± 2